

# 2 AXES NUMERICAL CONTROL TRAVELLING HEAD HYDRAULIC DIE CUTTING MACHINE



## RANGE OF APPLICATION

Die cutting application for a wide range of materials such as textiles, plastics, rubber, foam, composites, paper, woods, leather, cork, felt, as well as items like automotive upholstery, gaskets, filters, abrasives, shoe components, electrical insulation, medical supplies, packaging, shirt collars, sponges, caps, linings, luggage, toys, mouse pads, etc.

## ADVANTAGES

- A two axes servo-motor positioning system
- A cutting program that maximizes material yield, up to 20% savings
- 300 cutting programs available for different die shapes
- A 20 mm cutting stroke, along with a head traverse and material feeding distance of 50 mm, allows for a working capacity of 30,000 cuts per 8 hours
- The double chain drive travelling head mechanism has a positioning accuracy of  $\pm 0.5$  mm
- Touch screen operator interface
- The roll-type material auto cutting system uses either:
  - (1) Inboard pinch roll feeder for automatic feeding of one or two plys
  - (2) Inboard stroke adjustable clamping beam feeder for automatic feeding of multiple plys



## SPECIFICATIONS

MODEL	CP 2071-25E	CP 2071-30E
CUTTING FORCE	25 tons	30 tons
OPEN DAYLIGHT (Head to bed)	30 ~ 160mm	30 ~ 160mm
TRAVERSE SPEED	900 mm/sec	900 mm/sec
DOWN SPEED	183 mm/sec	145 mm/sec
UP SPEED	206 mm/sec	133 mm/sec
CUTTING HEAD	500 x 500 mm	500 x 500 mm
MACHINE BED	500 x 2100 mm	500 x 2100 mm
MAX. HEAD TRAVERSE	1550 mm	1550 mm
MAIN MOTOR	3 HP	5 HP
SERVO MOTOR	1 HP x 2	1 HP x 2
NET WEIGHT	2800 kg	3000 kg
DIMENSION(mm) (MACHINE ONLY)	2450W x 900D x 2200H	2450W x 900D x 2200H

## FEEDING SYSTEMS

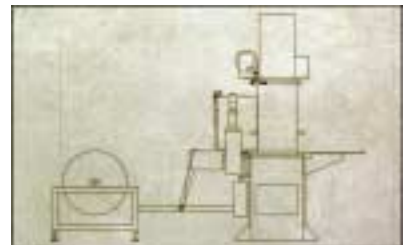

Inboard pinch roll feeder

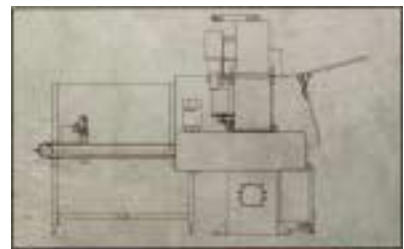

Inboard clamping beam feeder



The Cutting Force

**ASSOCIATED PACIFIC MACHINE CORP.**  
724 Via Alondra Camarillo, California 93012-8713  
Phone (805) 445-4740 • Fax (805) 445-4750  
Toll-Free: (800) 679-APMC  
www.apmcorp.com E-mail: sales@apmcorp.com

# 2 Axes Numerical Control Travelling Head Hydraulic Die Cutting Machine



**MODEL  
USA  
CP 2071-30E**



***The Cutting Force***